

FUSION™

OPERATOR'S MANUAL



STAHL'S
Hotronix®

a GroupeSTAHL company

Safety Instructions

**When using your heat press,
basic precautions should always be followed,
including the following:**

1. Read all instructions.
2. Use heat press only for its intended use.
3. To reduce the risk of electric shock, do not immerse the heat press in water or other liquids.
4. Never pull cord to disconnect from outlet, instead grasp plug and pull to disconnect.
5. Do not allow cord to touch hot surfaces, allow heat press to cool completely before storing.
6. Do not operate heat press with a damaged cord, or if the equipment has been dropped or damaged. To reduce the risk of electric shock, do not disassemble or attempt to repair the heat press, take it to a qualified service person for examination and repair. Incorrect reassembly or repair could cause a risk of fire, electric shock, or injury to persons when the equipment is used.
7. Close supervision is necessary for any heat press being used by or near children. Do not leave equipment unattended while connected.
8. Burns can occur when touching hot metal parts.
9. To reduce the likelihood of circuit overload, do not operate other high voltage equipment on the same circuit.
10. If an extension cord is necessary, then a 20 amperage rated cord should be used. Cords rated for less amperage may overheat, care should be taken to arrange the cord so that it cannot be pulled or tripped over.

SAVE THESE INSTRUCTIONS

Safety Instructions	2
Machine View	4
Touch Screen Guide	5
Operating Instructions	6-15
Connecting the System	6
Start Up/Shut Down	7
Operation Screen	8
Main Menu	9
Passwords	10
Setup Menu	11-14
Display Setup	11-12
Auto On/Off Setup	12
Presets Setup	13-14
Printing Pressing	15
Replacement Parts List and Location Guide	16-17
Electrical Schematic	18
Contact	19



■ Menu Selection Screen

A scrollable Menu Selection screen provides a quick and easy navigation to system operations. Use the Up/Down arrow buttons on the Menu Selection Screen to scroll through the available menus. The large menu button in the middle displays the selected menu. Press this Menu Button to choose the menu selection. The smaller top and bottom menu button displays the previous and next menu selections. (Fig.1)

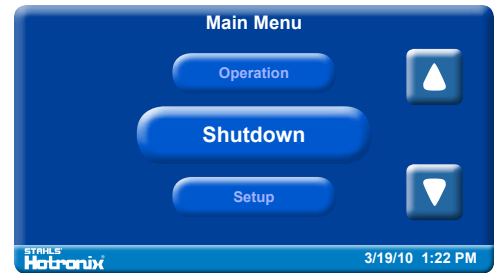

Fig.1

■ Control Bar

Each screen has a control bar display at the bottom. This bar displays the current Date, Time and the Stahls' Hotronix® logo.

■ Editing

Editable fields are displayed as text boxes with a white background. Selecting an editable field will display a Keypad that can be used to edit the field value. (Fig.2)



Fig.2

■ Increasing / Decreasing Values

In addition to editable fields, an Up/Down arrow button may be provided to increase or decrease values, or scroll through a list of values. The Up/Down arrow button (in most cases) can be held down to automatically increase or decrease the value. (Fig.3)

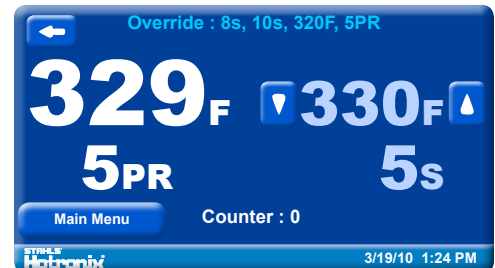

Fig.3

■ Navigation

Most screens have a Cancel or Back button to close the current screen without saving any changes and will return the user to the previous screen. (Fig. 4)

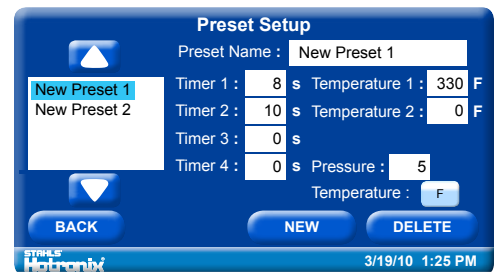

Fig.4

■ Keyboard / Keypad Display

The Keyboard/Keypad display is used for data entry purposes. The Keypad can be used to enter text or numeric data when required. It also provides function keys for Cancel, Enter, and Backspace/Clear (“<”) keys. Also a mode key may be present between the Cancel and Enter key. The mode key can switch between upper and lower case letters and numeric and other characters that maybe entered using the Keyboard/Keypad. Typically the current value is displayed in the Keypad value display at the top of the screen. Use the Keypad to change the current value. Use the Enter key to accept the change or the Cancel key to exit without accepting the change to the current value. The Keyboard/Keypad display is also used for password entry. Password characters will be displayed with “*” in place of the password value. (Fig.5)



Fig.5

HOTRONIX® FUSION™ Operating Instructions

HOTRONIX® FUSION™

The Hotronix® Fusion™ Operating Instructions are designed with the user in mind. Carefully read and follow the step-by-step instructions for best results.



- To avoid burns, do not touch the heated platen during use.
- Keep hands clear of the upper platen of the press during platen lock down as the pressure may cause injury.
- Press should be placed on a sturdy, suitable stand at least 36"L x 24"W x 29"H.
- Work area must be kept clean, tidy and free of obstructions.
- Power supply cord must be disconnected before cleaning or servicing press.

Connecting the System

1. Connect the power cord into the IEC inlet located in the back of the Press. (1.1)
Connect the opposite end of the cord into a properly grounded electrical outlet with a sufficient amperage rating.

- **Voltage**

120 Volt - The Hotronix® Fusion™ requires a full 20 amp grounded circuit for 120 volt operation.

240 Volt - The Hotronix® Fusion™ requires a full 10 amp grounded circuit for 240 volt operation.

- **Extension Cords**

If used, extension cords should be as short as possible and not less than 12 gauge. Heavy duty cords are recommended.

- **Circuits**

Circuits that have less than 15 amps or that have other high demand equipment or appliances (especially more than one heat seal machine) plugged in, should not be used.

Note: If the supply cord is damaged, it must be replaced by the manufacturer, its service agent or a similarly qualified person in order to avoid hazard. Use HSJ type, rated 250 V - 10 AMP for replacement.

CAUTION Failure to follow these instructions will cause:

1. Erratic controller functions.
2. Inaccurate displays and slow heat-up.
3. The circuit breaker to disengage.



1.1

Start Up

2. To start up your Fusion™ Press:



2.1

Flip the Power switch to the “On” position. (The power switch is located on the top of the control housing). (2.1) During the startup, a splash screen is shown for approximately 3 seconds. This screen displays the Hotronix® logo and current software version information. (2.2)



2.2

Shut Down

3. To shut down your Fusion™ Press:



3.1

Select the “Main Menu” button in the operation screen. (3.1)

Then select the “Shutdown” function in the Main Menu or flip the power switch to the off position. (3.2)



3.2



3.3

When the heat platen is above 100°F (38°C), the current platen temperature is displayed on a orange background as a warning of the current platen temperature. (3.3)



3.4

Note: During this time, the Shutdown operation can be exited by simply pressing the touch screen. The Dream Board will exit the Shutdown screen and return to the Main Menu.

Once the platen has cooled below 100° F (38° C), the touch screen will go blank. (3.4)

Operation Screen

4. The Operation Screen is the first screen displayed after the splash screen and start up has completed. This screen provides all the printing functions.

■ Presets

Saved Presets are displayed at the top of the Operation screen. Presets can be selected using the Left and/or Right arrow keys at the top left and right corners of the screen. Only the left arrow key is displayed when only one Preset is present. The Preset displays the Time1(s), Time 2(s), Temperature(F) and Pressure(PR). (4.1)

The example shown depicts a Preset with the name of “New Preset 1”, a first timer of 8 seconds, a second timer of 10 seconds, and a temperature of 330°F using a platen pressure of 5. (4.1)



4.1

■ Actual Readings

The Actual Temperature and Pressure readings are displayed on the left side of the Operation screen. These are the current Heat Press readings. (4.2)

■ Target Settings

Target Temperature and Timer settings are displayed on the right side of the screen. These settings may be overridden. (4.2)

To change these settings, select the Target Temperature and/or Timer display and adjustment Up/Down arrows will be displayed. Use the Up/Down adjustment arrows to change the Target Temperature and/or Timer. (4.3)

The Preset display name at the top of the screen will change to “Override” to indicate the Preset has been manually changed. (4.3)

Note: During the print process, the Target Timer setting will change to display a count down timer showing the remaining time on the printing process.



4.2

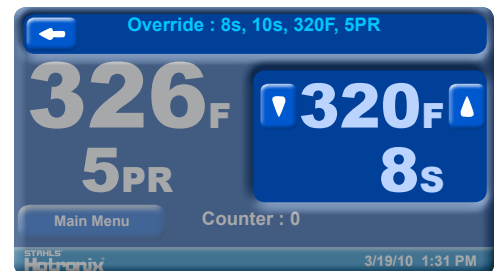

4.3

■ Job Counter

A Job Counter is displayed in the bottom middle of the screen. The Job Counter counts the total number of complete print cycles performed using the current Preset or Override settings. Exiting the Operation screen or changing the Preset will reset the Job Counter to 0. Changing an Override setting does not reset the Job Counter to 0. (4.4)

■ Main Menu Button

Use the Main Menu button to exit the Operation screen and proceed to the Main Menu. (4.4)



4.4

Main Menu

- 5.** The Main Menu provides access functions of the Fusion™ product. The available menus are: Shutdown, Setup, About, and Operation.



5.1

Select the “Operation” Menu to exit the Main Menu and return to the Operation screen. (5.1, 5.2)



5.2



5.3

Select the “About” Menu to display the Splash Screen. The Splash screen is displayed for approximately 3 seconds and returns to the Main Menu selection screen. This menu is useful for displaying the current software version and production information. (5.3, 5.4)



5.4



5.5

The “Setup” Menu selection screen provides additional system setup functions not accessible from the Main Menu. Those functions are: Presets, Display, Auto On/Off, and Main Menu. (5.5, 5.6)



5.6

Note: A Password is required to access the Setup menu. (refer to pgs 10 -11 for Login information)



5.7

Press the “Shutdown” menu to exit The Fusion™. (5.7, 5.8)

See page 7 for further details.



5.8

Passwords

- 6.** A password is required to access the Setup Menu and configure certain functions of the Hotronix® Fusion™.



6.1

In the Main Menu, press the "Setup" Menu. (6.1)

Then press the blank password field. (6.2)

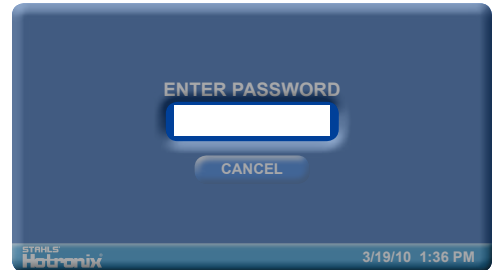

6.2



6.3

A Keyboard/Keypad will be displayed. (6.3)

Enter the letter "U" for a "User Level" password and press Enter when complete. (6.4)

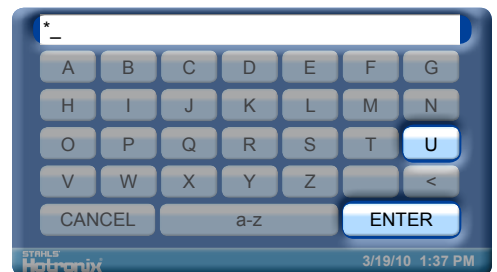

6.4



6.5

Note: You can Select the Cancel button to exit the Password Entry screen and return to the previous screen at any time. (6.5)

If an invalid password is entered, select the blank password field and repeat the previous step. (6.6)

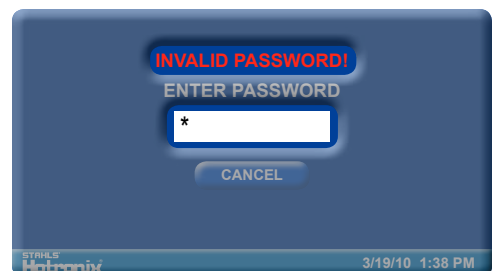

6.6



6.7

Now you will be automatically entered into the Setup Menu where you will have full access to all Setup functions. (6.7)



6.8

Display Setup

7. The Hotronix® Fusion™ functions and features can be configured using the Setup menu. These features include: Presets, Display, Auto On/Off, and Main Menu.

After your password is entered in the setup menu, scroll down and select the “Display” button. (6.8)

This option will allow you to configure the Temperature Units, Pressure Units, Display Language and to set the Date and Time. (7.1)



7.1

Temperature Units

The Temperature Units can be changed from F (Fahrenheit) to C (Celsius). This is a global setting and Temperature values will be displayed in the configured units. Select the Temperature Units button to toggle between “F” and “C.” Press the Save button to save any changes. (7.2)

Note: You will lose any changes if you leave the Setup Menu without pressing the “Save” button. You can also use the “Back” or “Cancel” buttons on Setup Screens to exit the screen and return to the previous screen.

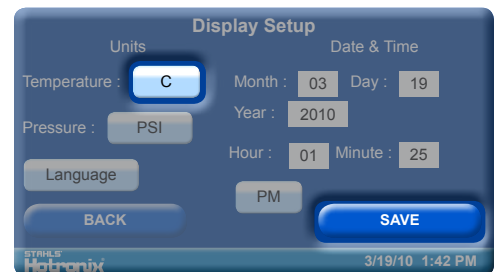

7.2

Pressure Units

The Pressure Units can be changed from PSI (Pressure per Square Inch) to kPa (kilopascals). Select the Pressure Units button to toggle between PSI and kPa. These are your global pressure settings that will be displayed in the configured units. Press the Save button to save any changes. (7.3)



7.3

Language

To change the display Language, select the Language button. The Language selection screen will be displayed. Use the Up/Down arrows to scroll through the available languages. Once the desired language is selected, press the “Save” button. (7.4)

Note: Changing and Saving the Language setting requires a restart of the Fusion™. The machine will automatically restart and return to the Operation screen using the new Language display settings.

Please refer to page 12 to configure the Date and Time.



7.4

Display Setup

■ Date and Time

To set the Date and Time, select the individual numeric display for the Month, Day and Year. A numeric Keyboard/Keypad will be displayed. (7.5)

Change the numeric value using the Keypad, then press “Enter” to save any changes.

Repeat the same process to set the Hour and Minute.

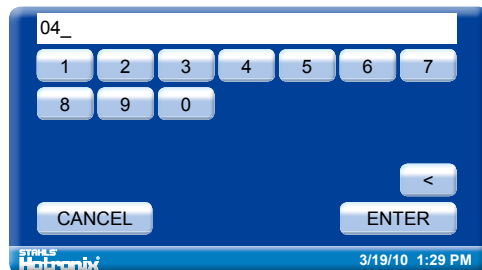

7.5

To change the AM/PM designator, select the AM/PM button to toggle between the AM/PM settings. (7.6)

Press the Save button to save the new Date and Time settings.

Note: It may take a few seconds for the Date and Time display to update on the Control Bar at the bottom of the screen.

Select the back button to return to the Setup menu. (7.6)

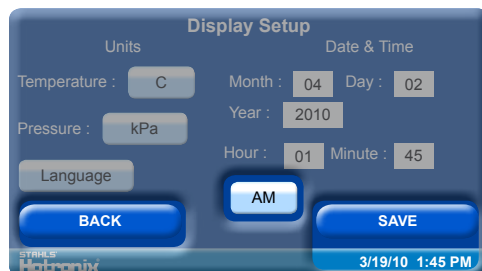

7.6

Auto On/Off Setup

8. The system can turn On or Off automatically when configured. The Auto On/Off feature is configured for each day of the week.

In the Setup Menu, Select the Auto On/Off Button. To configure an Auto On/Off setting, use the Up/Down selection arrows to select the day of the week to be configured. Use the Enable/Disable button to enable that day of the week setting. (8.1)

Note: Each day that you want the system to automatically turn On/Off, must be Enabled.



8.1

When enabled, set the time of day for Auto On and Off events by selecting the Hour and Minute fields. (8.2) Using the displayed Keyboard/Keypad, enter the numeric time values and press enter.

Use the AM/PM designator button to toggle between the AM or PM settings. Select the Save button to save the settings. (8.2)

Note: Selecting another day of the week or exiting the Auto On/Off Setup screen without saving will result in loss of changes.

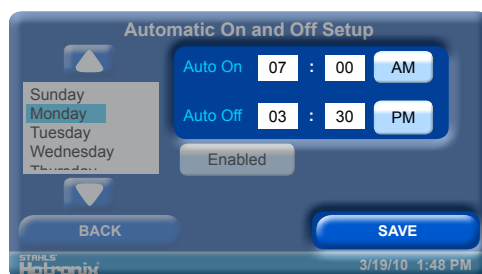

8.2

Presets Setup

- 9.** Presets are configured using the Preset Setup screen. A Preset can have 1 - 4 Timer values, 2 Temperature values, 1 Platen Pressure setting, and a descriptive Name.



9.1

In the Setup Menu, Select the "Presets" button. (9.1)

Use the Up/Down arrows to scroll through the list of Presets and select a Preset for editing. (9.2)

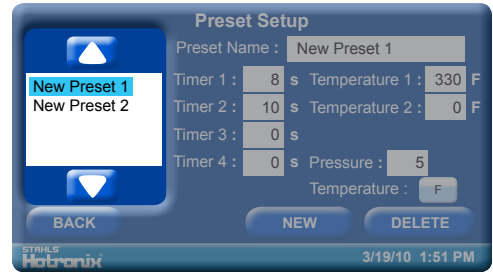

9.2

■ Preset Name

A descriptive name for identifying a Preset, limited to 20 characters in length. A Preset Name can be added to the Preset list by selecting the "New" button. (9.3)



9.3

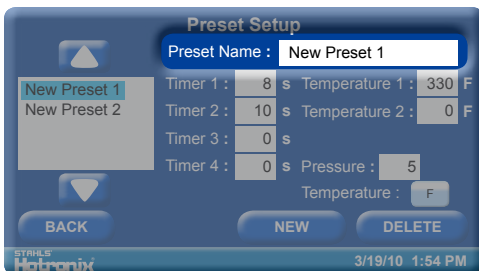

9.4

Enter a Preset Name by pressing the "Preset Name" field. (9.4)

A keyboard/Keypad will be displayed. Name the Preset and press "Enter." (9.5)



9.5

Press the "Save" button to save the new Preset. (9.6)

Note: The new Preset must be Saved before it can be displayed in the list. Also, any changes to a Preset must be Saved before selecting a new Preset in the list and before exiting the Preset Setup screen or any changes will be lost.

Press the Delete button if you wish to remove any selected Preset from the list. (9.6)

Note: this function cannot be undone.

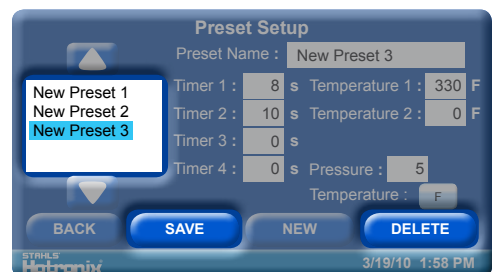

9.6

Presets Setup

■ Timer

Timers can be set using values 0 – 999 seconds. Entering a value of 0 seconds disables a Timer and it will not be used or displayed in the Preset selection on the Operation screen.

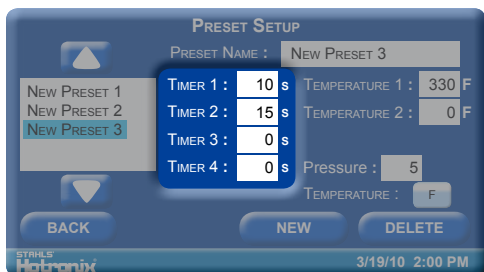

9.7

Select the “Timer” field (Timer 1,2,3 or 4) to open a Keyboard/Keypad to change the Timer setting. (9.7)

Select the desired time and press “Enter”. (9.8)



9.8

■ Temperature

Temperatures can be set from 32°F - 430°F (0° - 221°C). Setting a Temperature value to 0 (Fahrenheit) disables the Temperature setting. Select the Temperature field to open a Keyboard/Keypad to change the Temperature settings. (9.9)

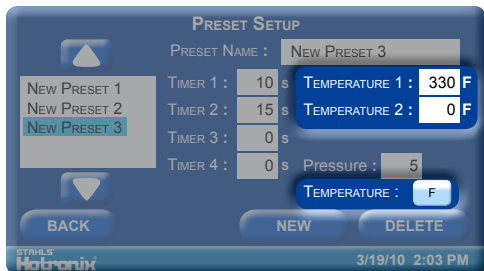

9.9

Use the Temperature F or C button to toggle the Temperature units for display and/or entry between Fahrenheit and Celsius. (9.9)

Select the desired temperature and press “Enter”. (9.10)

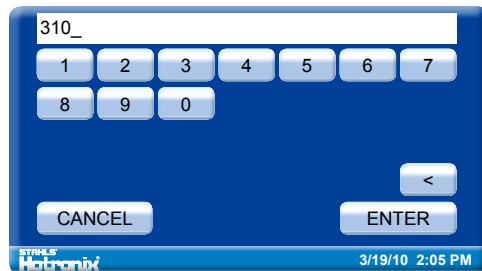

9.10

■ Pressure

This is the recommended Preset Platen Pressure setting. This has a valid range of 0 - 9. A “0” Pressure readout would indicate no pressure at all and “9” would indicate very heavy pressure.



9.11

Select the Pressure field to display a Keyboard/Keypad for editing this value. (9.11,)

Select the desired pressure and press “Enter.” (9.12)

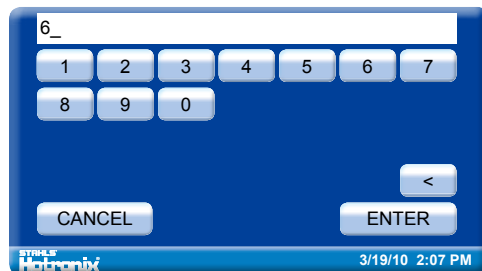

9.12

Printing / Pressing

10. Prepare to Print

To begin Printing / Pressing, go to the Main Menu and select “Operation” to enter the Operation screen. (10.1)

Note: Be sure you have the correct Preset selected for your application.



10.1

You may also manually adjust your desired Time, Temperature and Pressure settings (refer to pg 8).

Note: Be sure the Actual press Temperature has reached the Target Temperature, (10.2)



10.2

When the desired settings are reached you may begin to Print / Press.



10.3

When using the “Swing” feature: Swing the heat platen out and position the garment and application. (10.3)

When using the “Draw” feature: Pull out the lower platen and position the garment and application. (10.4)



10.4

Swing the heat platen or push the lower platen back into position. Then lower the heat platen into the press position.

The Timer display will automatically initiate a count down and visually and audibly signal you when to lift the platen off the garment. Immediately lift the platen to the UP position. (10.5)

Swing the heat platen or pull the lower platen away and proceed according to your application’s instructions.

Your equipment has automatically reset and you may continue to Print / Press.



10.5

HOTRONIX® FLUSSION™

Replacement Parts List

Item #	Part Name	Part #	Qty.
1	Base Assembly	4-1175	1
2	Rubber Foot	1-2199	4
3	Right Upper Link	Kit 3-6929	1
4	Low Profile SHCS	3-1011-245	2
5	Stop Collar	1-2203	1
6	Hex Nut	2-1006-93	1
7	Hand Retractable Plunger	1-2206	2
8	Steel Pin	1-2204	1
9	Upper Casting	2-1664	1
10	Washer	2-1006-21	1
11	Castle Nut	2-1006-1	1
12	Adjustment Casting	1-2162	1
13	E-Clip	1-1019-1	1
14	Steel Shim	1-2217	1
15	Adjustment Spindle	1-1010-2	1
16	Adjustment Knob	1-1012	1
17	Spherical Washer	2-1006-92	1
18	Ball Plunger	1-2201	1
19	Roll Pin	1-1018-1	2
20	Swing Knob	1-1054	1
21	Lift Rod Bushing	1-1013	1
22	Left Upper Link	Kit 3-6929	1
23	Guide Tube	1-2194	1
24	Undercarriage	Kit 3-6911	1
25	Handle Spacer	0175-12	1
26	Foam Grip	1-2116	1
27	Lift Link	1-1024	2
28	Clevis Pin	1-1017-1	2
29	Nylon Lock Nut	2-1006-20	2
30	Screw, Cap But Hd. 3/8-16 x 3/4"	3-1011-244	3
31	Inner Lift Arm (Thick)	1-2207	2
32	Bearing	1-1300	2
33	Outer Lift Arm (Thin)	1-2208	2
34	C-Frame	3-1335	1
35	Slide Rail	1-1749	2
36	Draw Tray	1-2164	1
37	Compression Spring	1-2195	6
38	Nylon Washer	2-1006-65	6
39	Shoulder Bolt	3-1011-121	6
40	Draw Handle	1-2182	1
41	Quick Change Pin	1-2215	1
42	Adaptor Plate	3-1336	1
43	Lower Platen	2-1029	1
44	Silicone Pad 16"x20" (Blue)	1-2136	1
45	Heat Platen (16"x20")	2-1002	1
46	Heater Cover	1-2189	1
47	Finish Washer	1-1063	4
48	Cover Screw	3-1011-217	4
49	Touch Screen Controller	1-2167	1
50	Control Housing Overlay	1-2198	1
51	Control Housing	1-2197	1
52	Power Switch	1-2087	1
53	Breaker	1-1331	1
54	IEC Inlet	1-1759	1
55	Power Coard	2-1013-1	1

HOTRONIX® FLUION™

Parts Location Guide

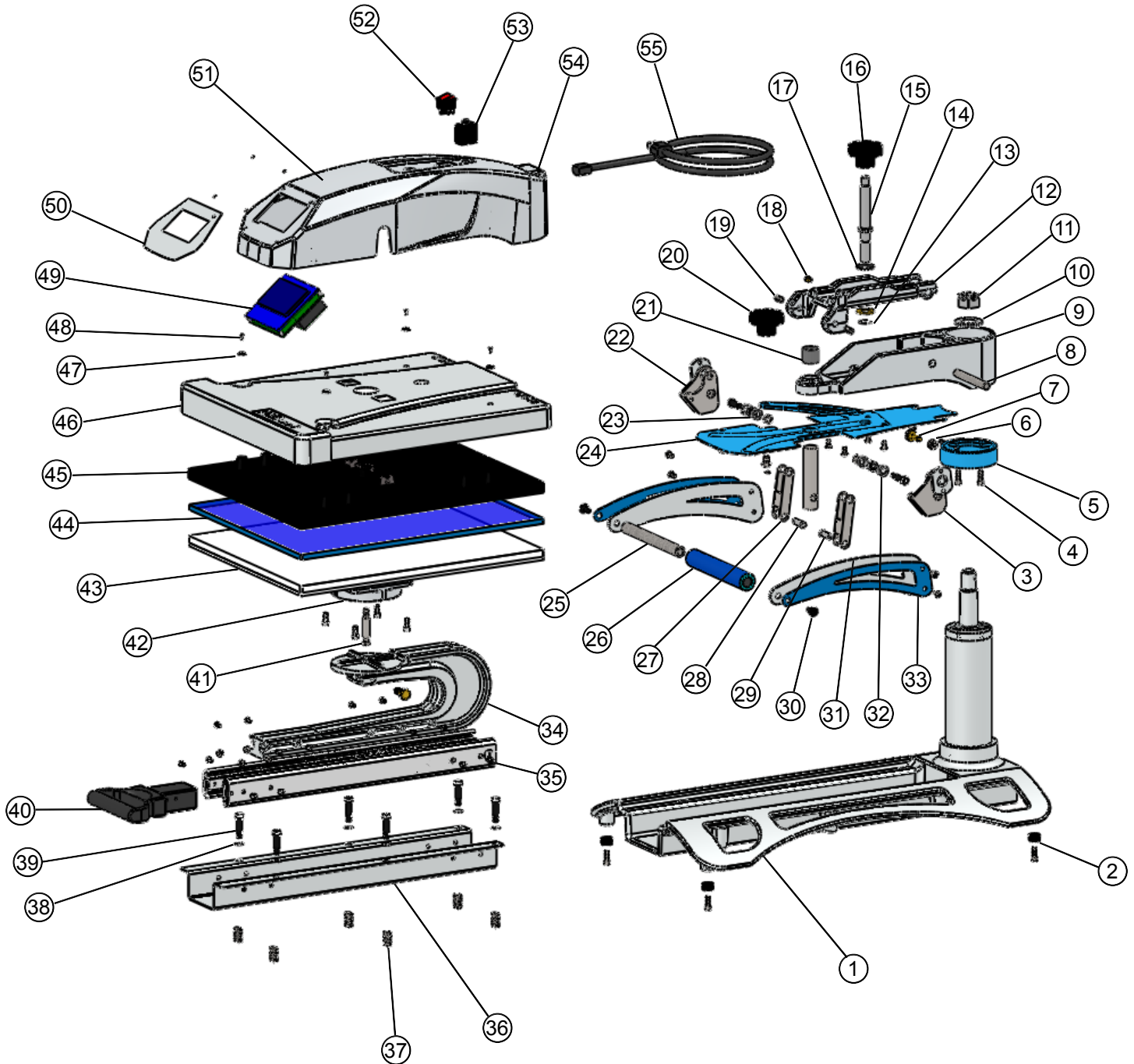



Contact us

Stahls' Hotronix®
One Paisley Park
Carmichaels, PA 15320
U.S.A.

Technical Support
800 . 727 . 8520
Monday - Friday
8am - 7pm EST

Customer Service
800 . 727 . 8520
Monday - Friday
8am - 5pm EST

Replacement Parts
800 . 727 . 8520
8am - 7pm EST

Web
Hotronix.com



This document includes multiple trademarks and describes equipment covered by many patents that are owned by GroupeSTAHL and/or its subsidiaries. GroupeSTAHL enforces its rights to protect these intellectual properties. © 2011

®



Proudly made in the U.S.A.

One Paisley Park . Carmichaels, PA 15320, U.S.A.
Tech Support - Customer Service - Replacement Parts: 800 . 727 . 8520
Web: Hotronix.com

STAHL'S
Hotronix®
a GroupeSTAHL company